



ADMIRAL
STAGING

Original user manual

TRUSS WALL MOUNT 30



Manufacturer:

Rolight Theatertechniek B.V.

Josink Kolkweg 10

7545 PR Enschede , The Netherlands

Phone (+31)53 432 06 44

info@rolight.nl

www.rolight.nl

Distributed by ADMIRAL

VERSION 01
September 2024
SKU: RIHTWB30
RIHTWC30

www.admiralstaging.com

CONTENTS

1. INTRODUCTION
2. SAFETY INSTRUCTIONS
3. SCOPE
4. LIMITATIONS OF USE
5. TECHNICAL DATA & LOADCHART
6. IDENTIFICATION
7. EXPLANATION OF THE STICKER
8. ASSEMBLY INSTRUCTIONS
9. MAINTENANCE & REJECTION CRITERIA
10. WARRANTY
11. MANUFACTURES DECLARATION OF CONFORMITY

1. INTRODUCTION

The ADMIRAL TRUSS WALL MOUNT 30 allows for the horizontal installation of a truss construction between walls.

The TRUSS WALL MOUNT 30 is intended for permanent installations in the entertainment industry but is also suitable for use in museums, event venues, theatres etc. as well.

ADMIRAL has endeavored to deliver the highest degree of accuracy possible. However continuous improvement of our products is ADMIRAL policy. Therefore product specifications are subject to change without notice. Readers and users are encouraged to notify ADMIRAL of errors and send in suggestions for improvements. All communications will be carefully considered for future printings of this manual and changes to our products.

2. SAFETY INSTRUCTIONS

This user manual must be read and understood prior to assembly, setup and servicing. All people using and servicing the TRUSS WALL MOUNT 30 must familiarize themselves with the safety instructions and user guidelines written in this manual. This manual needs to be accessible for all users at all times.

LEGEND



DANGER

DANGER: Indicates a hazardous situation which, if not avoided, will result in death or serious injury.
This signal word is to be limited to the most extreme situations.



WARNING

WARNING: Indicates a hazardous situation which, if not avoided, could result in death or serious injury.



CAUTION

CAUTION: Indicates a hazardous situation which, if not avoided, could result in minor or moderate injury.

NOTICE

NOTICE: Addresses practices not related to personal injury.

SAFETY INSTRUCTIONS

SAFETY INSTRUCTIONS: Is used for lists of steps, procedures or instructions that might otherwise substitute a DANGER, WARNING or CAUTION notification. Note that equivalent phrases, such as SAFE OPERATION PROCEDURES or SAFE SHUT DOWN PROCEDURE, can be used in place of the words "SAFETY INSTRUCTION".



CAUTION

- A TRUSS WALL MOUNT 30 must be taken out of service immediately if, during use, repair or maintenance damages are discovered.
- Remove people from the area during installation.
- Use solely instructed and/or trained personnel.
- Wear appropriate Personal Protective Equipment (PPE) such as hard hats and gloves during the installation.
- Make sure there is adequate amount of working light during the installation of the product.



WARNING

Dynamic factor of lifting must be considered separately.

- The TRUSS WALL MOUNT 30 can be operated from -20° up to 60° Celsius.
- The maximum allowable load, including the self-weight of the truss structure, is 400 kg, provided that the walls to which the brackets are mounted can support this load.
- Make sure the resulting forces on the supporting structure are approved by a competent person before applying the load.
- To determine the maximum suspended load on the product, all imposed loads shall be considered. e.g. the dynamic factor caused by the lifting machinery.
- The TRUSS WALL MOUNT 30 must be inspected by a competent person as often as required but with a minimum of 1 x per year. Records of these inspections must be kept.
- Inspect equipment before every use. A damaged TRUSS WALL MOUNT 30 shall be taken out of service.
- Outdoor use shall be approved by a competent person and might influence the load capacity. Do not expose the product to full rain or snow. Outdoor use is the sole responsibility of the operator.
- In case of use in the vicinity of saltwater, the product shall be rinsed regularly with fresh water to avoid corrosion.
- It is also imperative to observe the local accident prevention regulations and/or occupational health and safety regulations.
- The support structure, on which the TRUSS WALL MOUNT 30 is used, might need to have electric potential bonding.
- Make sure the TRUSS WALL MOUNT 30 and the supporting structure are dry and free of dirt.
- Do not use the TRUSS WALL MOUNT 30 to guide currents for electric potential bonding.
- Use appropriate packaging to transport the products. e.g. a flightcase.
- Solely use by ADMIRAL approved parts to replace damaged or lost parts.
- Do not re-zinc steel components as they might be subject to hydrogen embrittlement.
- The TRUSS WALL MOUNT 30 is designed to be used in normal environmental conditions.

3. SCOPE

The intended use of the TRUSS WALL MOUNT 30 is to support and fix a 290mm wide truss to a wall without the need for additional suspension from the ceiling. It supports loads of up to 400 kg (including the weight of the truss construction) per TRUSS WALL MOUNT 30, vertically from the support structure. Loads can be lighting fixtures, video projectors, sound systems and/or equipment.



WARNING

Check local legislation for the application of use.

4. LIMITATIONS OF USE



WARNING

Exceeding the limitations of use can severely endanger the audience and users.

- Do not use the TRUSS WALL MOUNT 30 in e.g. swimming pools or other spaces with polluted air conditions.
- Place the truss in the TRUSS WALL MOUNT 30 at least as far as the bolt for the clamp strip will sit behind the end brace.

WARNING

Do not tilt truss spans.

Side view

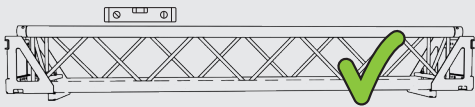
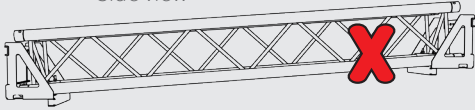

Ensure that the TRUSS WALL MOUNT 30 is aligned correctly to distribute forces evenly within the truss structure.

Top view

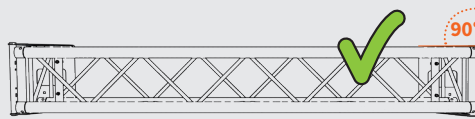
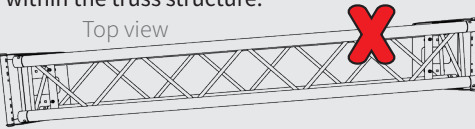

WARNING

The clamping strip shall sit behind the first end brace as a minimum.

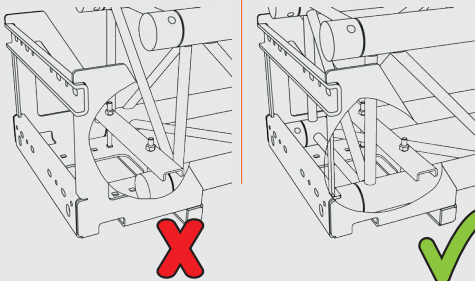

WARNING

Distribute the load evenly.

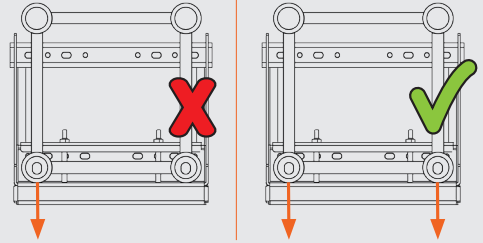

WARNING

The allowable load from the TRUSS WALL 30 strongly depends on the total supporting wall structure. A load that is too heavy can cause the structure to fail.

CAUTION

Do not throw the TRUSS WALL MOUNT 30, as it might damage the product.

5. TECHNICAL DATA & LOADCHART

Top view

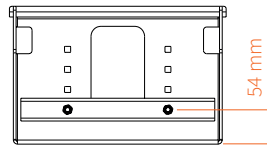

Front view

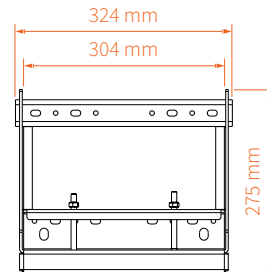

MAX LOAD
400kg

Side view

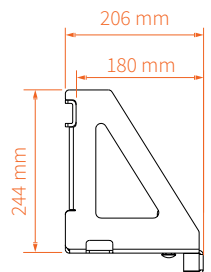

Technical data

Article code:	RIHTWB30
EAN:	8720094422268
Max load:	400 kg
Material:	steel
Weight:	11 kg
Dimensions:	324 x 275x 206 mm (L x W x H)
Colour:	black RAL 9005 30% gloss
Finish:	powder coated

Article code:	RIHTWC30
EAN:	8720094422275
Max load:	400 kg
Material:	steel
Weight:	11 kg
Dimensions:	324 x 275x 206 mm (L x W x H)
Colour:	silver
Finish:	zinc plated

Applicable Directives, Regulations, Standards and Information Papers

Eurocode normalisation

NEN-EN 1990	(Eurocode 0) Basic of structural design
NEN-EN 1990	(Eurocode 1) Action on structures
NEN-EN 1990	(Eurocode 3) Design of steel structures

6. IDENTIFICATION

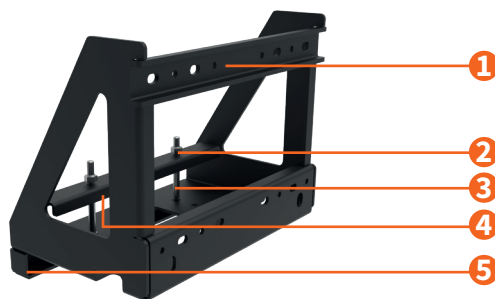

TRUSS WALL MOUNT 30

- 1 Bracket strip
- 2 Nut M8 nylock nut
- 3 Bolt M8x90
- 4 Fixation profile
- 5 Bracket 30 truss

7. EXPLANATION OF THE STICKER

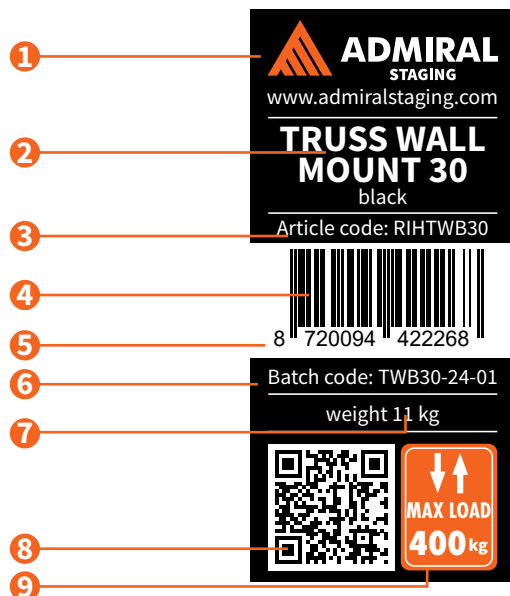

TRUSS WALL MOUNT 30 sticker

- 1 Brand name
- 2 Product name
- 3 Article code
- 4 Barcode
- 5 EAN code
- 6 Batch code*
- 7 Weight
- 8 QR code to online manual
- 9 Max load

*Based on the Batch code ADMIRAL is able to trace the date of manufacturing

8. ASSEMBLY INSTRUCTIONS



WARNING

Inspect the TRUSS WALL MOUNT 30 before use. Make sure all components are in place and in good order. If damaged, mark the item clearly and take out of service*.

Make sure the TRUSS WALL MOUNT 30, the truss structure and the surface are dry and free from dirt.

*See chapter 9 for further instructions!

Note

Use an M8 anchor or bolt (8.8 quality) to connect the TRUSS WALL MOUNT 30 onto the wall structure. The torque setting shall be 15 Nm minimum.

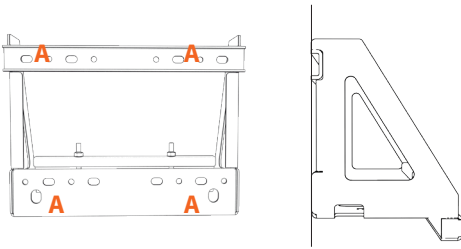

Step 1

Mount the TRUSS WALL MOUNT 30 to the wall. Drill some holes in the wall (see plate for positions **A**) and fix the TRUSS WALL MOUNT 30 to the wall

Mount the other TRUSS WALL MOUNT 30 at the exact same height on the opposite wall.

Step 2

Connect the truss construction to reach the total length (**B**) between the two TRUSS WALL MOUNTS 30s.

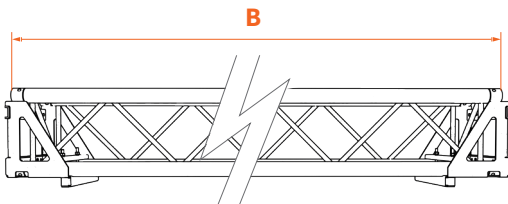

Step 3

Adjust the truss positioning and the fixation profile so the fixation profile (**C**) fits between the truss and can be connected to the TRUSS WALL MOUNT 30. Place the truss in the TRUSS WALL MOUNT 30 at least as far as the bolt for the clamp strip will sit behind the end post.

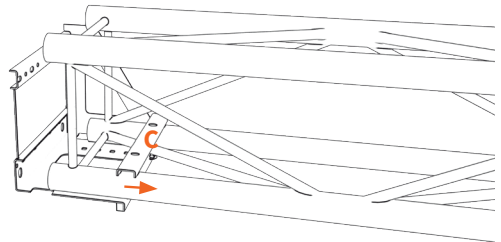
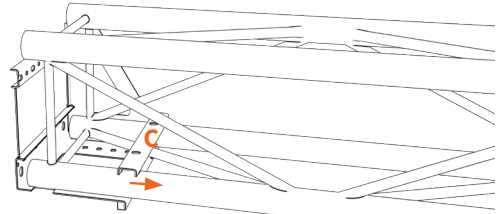
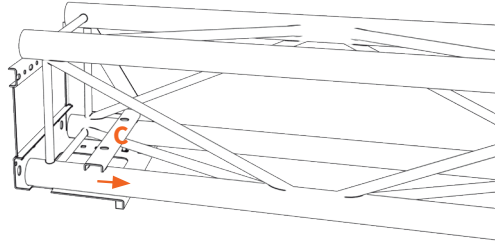

Step 4

Insert the bolt from below the bracket strip through the holes and the fixation profile. Secure it with M8 Nyloc nuts and hand tighten the bolt/nut.

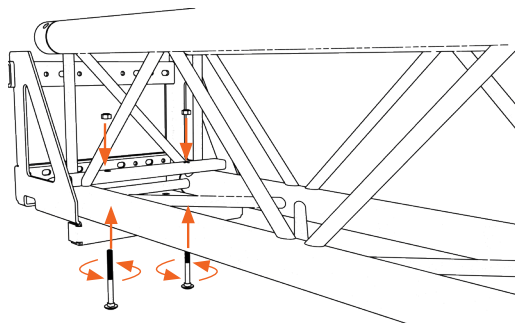



WARNING

Check the integrity of the TRUSS WALL MOUNT 30 after severe vibrations.



CAUTION

When replacing parts, only use genuine ADMIRAL components.

9. MAINTENANCE & REJECTION CRITERIA

SAFETY INSTRUCTIONS

The TRUSS WALL MOUNT 30 hardly needs any maintenance under normal use and environmental circumstances. For safety reasons however, all parts must be checked regularly for dirt, damages, loss and corrosion.

The TRUSS WALL MOUNT 30 shall be checked in compliance with the local law by a competent person. Checking shall take place as often as required but with a minimum of 1x per year. In case of doubt contact ADMIRAL.

- Check all components for damages like cracks, deformations, scratches and and corrosion. Damaged and corroded parts shall be rejected and thrown away.
- In general, scratches > 10% of the wall thickness mean the product needs to be rejected from use.
- In general, deformations > 10% of a straight line from the outer surface mean the product needs to be rejected from use.
- Remove all sharp and rough feeling edges and surfaces by using sand paper or a file.
- Check roll pins and welds for cracks. If cracked, replace.
- Inspect the internal wire thread to ensure it is in good condition.



WARNING

If damaged, mark the item clearly and take it out of service.



WARNING

Do not use the TRUSS WALL MOUNT 30 outside. Make sure no horizontal forces, like wind, are acting on the system.

10. WARRANTY

- For a period of 24 months we will repair, free of charge, any damage attributable to faulty materials or workmanship under the condition that the equipment is forwarded, freight paid, to our warehouse or one of the ADMIRAL distributors' warehouses.
- The warranty-period begins with the day of the delivery, proven by a purchase receipt like an invoice or delivery note or their copies.
- The warranty does not cover damage due to transport, negligent handling, overloading the equipment or parts subject to normal wear and tear signs. Nor damages that originate from a case of misuse because of nonobservance of the safety regulations in this instruction manual.
- The warranty will be invalid when other parts than the original ADMIRAL parts have been used or modifications of our design have been made by third parties.
- Warranty repairs do not renew nor extend the warranty-period.
- In case of a claim that falls under the warranty, e.g. a malfunction or spare part requirements, please contact your point of sale or ADMIRAL.
- The manufacturer is not liable for indirect consequential damage and financial loss.
- The manufacturer shall not be liable for any changes made to the TRUSS WALL MOUNT 30 parts nor for any damage resulting from such changes.

11. MANUFACTURES DECLARATION OF CONFORMITY



MANUFACTURES DECLARATION OF CONFORMITY

Rolight Theatertechniek
Josink Kolkweg 10
7545 PR Enschede
The Netherlands

Herewith declares that:

ADMIRAL "TRUSS WALL MOUNT 30"; article code RIHTWB30 & RIHTWC30

- the following harmonized standards have been used (or parts/clauses of): EN 12100-1-2010
- part/clauses of the following technical regulations , standards and information papers have been used: German DGUV 17-18, German DGUV 215-313, EN 10204:2004, EN 17206 :2020, BS 7905-1 :2001
- all TRUSS WALL MOUNT 30s are tested with a static test coefficient of 150 % of the work load

Enschede , The Netherlands 7-September-2023

Ms. E. Dijk
Owner Rolight Theatertechniek b.v.



Rolight

